

REVISIONS		
NO.	NAME	DATE

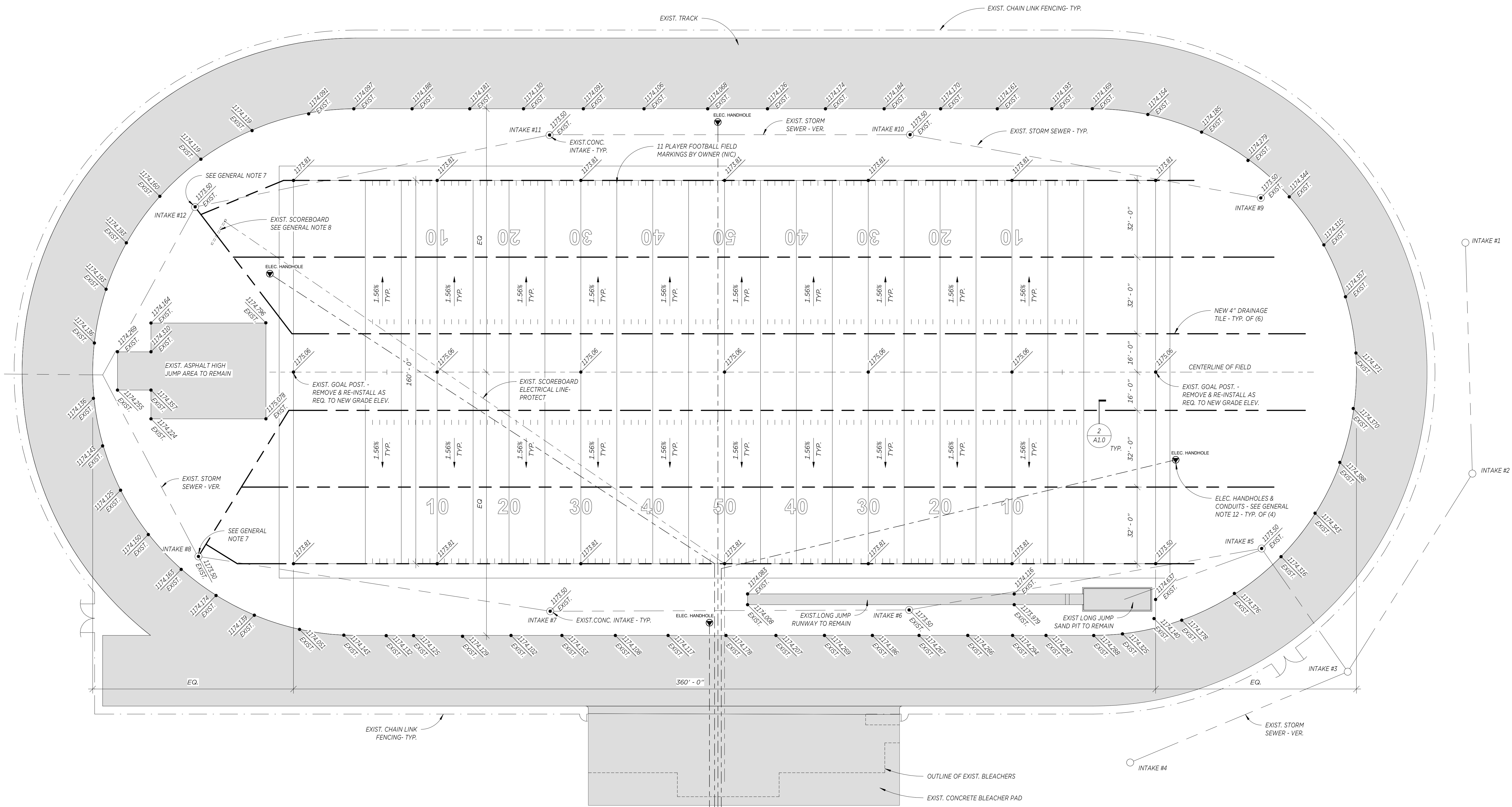

**1 SITE PLAN**  
A1.0 SCALE: 1" = 20'-0"

**GENERAL NOTES**

- PRIOR TO PROCEEDING WITH THE WORK, THE CONTRACTOR SHALL VERIFY ALL EXISTING CONDITIONS AND DIMENSIONS.
- IT IS NOT THE INTENT OF THE DRAWINGS TO SET FORTH IN DETAIL OR TO OTHERWISE DIRECT EVERY ITEM PROPERLY NECESSARY TO THE COMPLETION OF THIS PROJECT. THE CONTRACTOR MUST RECOGNIZE THAT IT IS HIS SOLE RESPONSIBILITY TO BE FULLY QUALIFIED FOR THE WORK AND THAT HE MUST WITHOUT DIRECTION, ACCOMPLISH EVERYTHING NECESSARY SO AS TO PROVIDE A GOOD AND WORKMANLIKE CONSTRUCTION COMPLETE IN EVERY NECESSARY RESPECT AND IN ACCEPTABLE CONDITIONS, READY FOR USE WITHOUT ANY ADDITIONAL WORK BEING REQUIRED OTHER THAN EXPLICITLY STATED IN THE CONTRACTOR'S PROPOSAL.
- CONTRACTOR SHALL REMOVE AND REPAIR ALL ITEMS DAMAGED BY THE PROJECT WORK AT NO EXPENSE TO THE OWNER.
- THE CONTRACTOR SHALL BE RESPONSIBLE FOR OBTAINING ALL PERMITS REQUIRED FOR COMPLETION OF THE PROJECT INCLUDING, BUT NOT LIMITED TO, IOWA DNR WATER DISCHARGE PERMITS.
- FOR EXISTING GRADES REFER TO SITE SURVEY BY HEROLD - REICKS SURVEYING.
- REGRADE BETWEEN THE EXIST. CONC. INTAKES AS REQ. TO PROVIDE POSITIVE DRAINAGE TO THE INTAKES.
- CORE DRILL EXIST. CONC. INTAKE AS REQ. FOR NEW CONNECTION FOR DRAIN TILE.
- EXIST. SCOREBOARD. LOCATE ANY AND ALL BURIED ELECTRICAL LINES BEFORE TRENCHING DRAINAGE TILE.
- GRADING CONTRACTOR SHALL STRIP AND SALVAGE A MINIMUM OF TWELVE INCHES (12") OF TOPSOIL FROM THE FOOTBALL REGRAIDING AREA. PRIOR TO STRIPPING TOPSOIL, THE CONTRACTOR SHALL TREAT THE AREA WITHIN THE EXISTING TRACK WITH A BROAD SPECTRUM HERBICIDE AND ALLOW TIME TO ELIMINATE EXISTING VEGETATION. PRECAUTIONS SHALL BE TAKEN TO PROTECT SURROUNDING AREA FROM DRIFT AND OVERSPRAY. SALVAGED TOPSOIL SHALL BE PLACED AND SPREAD OVER THE REGRADED FOOTBALL FIELD AFTER ALL GRADING AND TRENCHING ACTIVITIES IN THE AREA HAVE BEEN COMPLETED AND PRIOR TO SODDING. GRADING CONTRACTOR SHALL COMPACT THE REGRADED FOOTBALL FIELD UTILIZING IDOT TYPE A COMPACTION.
- PERMANENT MARKERS FOR STRIPING: CONTRACTOR SHALL PLACE PERMANENT MARKERS FOR USE IN MARKING THE FOOTBALL FIELD BY THE OWNER. THE CONTRACTOR SHALL USE THE 50 PIECE PROLINE LAYOUT AND MARKING SYSTEM AS MANUFACTURED BY JAYPRO SPORTS LLC, OR EQUIVALENT AS APPROVED BY THE ARCHITECT. CONTRACTOR SHALL PLACE MARKERS FOR (1) PLAYER FIELD LAYOUT AND SHALL CONSULT WITH THE OWNER FOR LOCATING ON THE FIELD.
- SOILS CUT OUT FOR REGRAIDING SHALL BE DISPOSED OF ON-SITE. COORDINATE LOCATION W/ OWNER & LEVEL OFF (ROUGH GRADE).
- ALTERNATE NO. 2 - ELECTRICAL HANDHOLES. VERIFY LOCATIONS WITH OWNER. PROVIDE EXTERIOR GRADE HANDHOLES W/ A COVER (CARSON INDUSTRIES L-SERIES 1419-12, OR APPROVED EQUAL). FURNISH & INSTALL (1) 1" & (2) 2" EMPTY SCHEDULE 40 PVC ELECTRICAL CONDUITS WITH PULL WIRE AND CAP.

**SITE LEGEND**

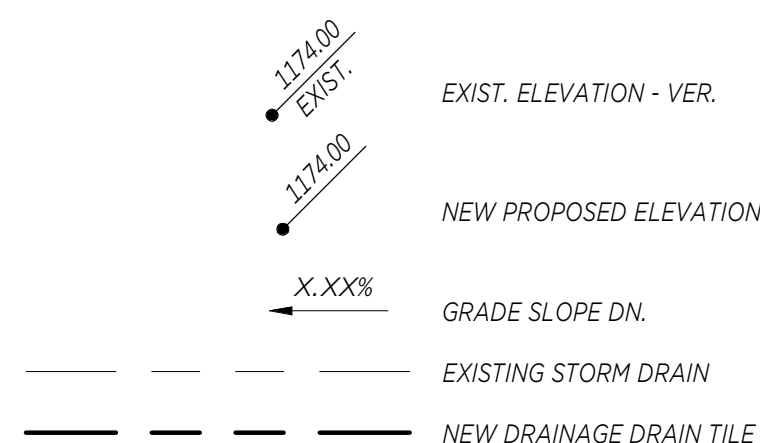

**2 DRAIN TILE SECTION**  
A1.0 SCALE: 1 1/2" = 1'-0"

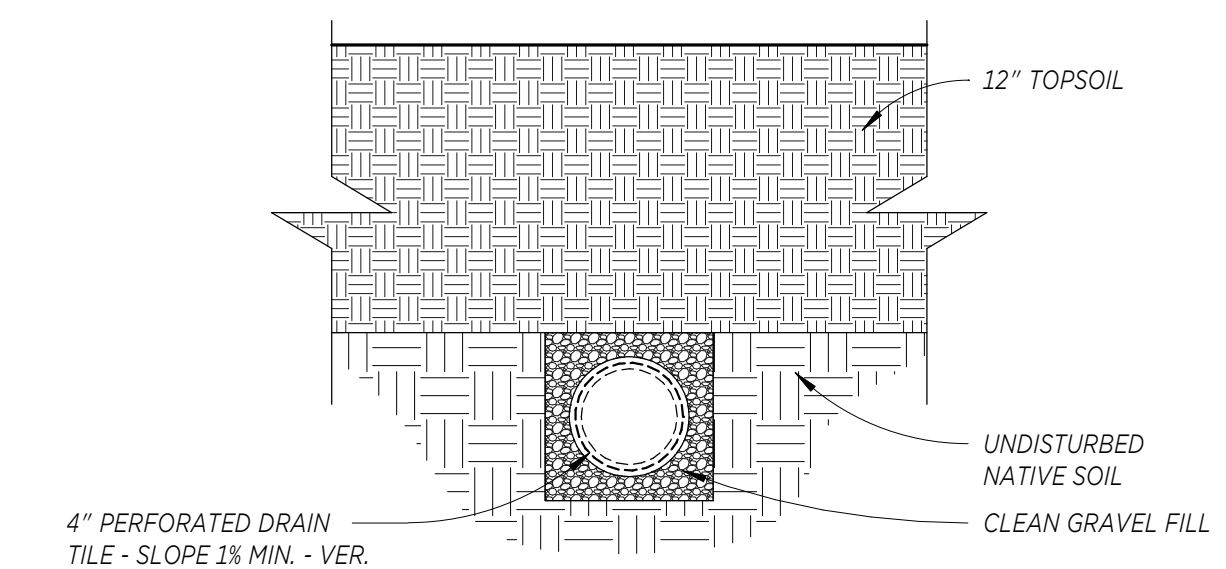

REVISIONS		
NO.	NAME	DATE

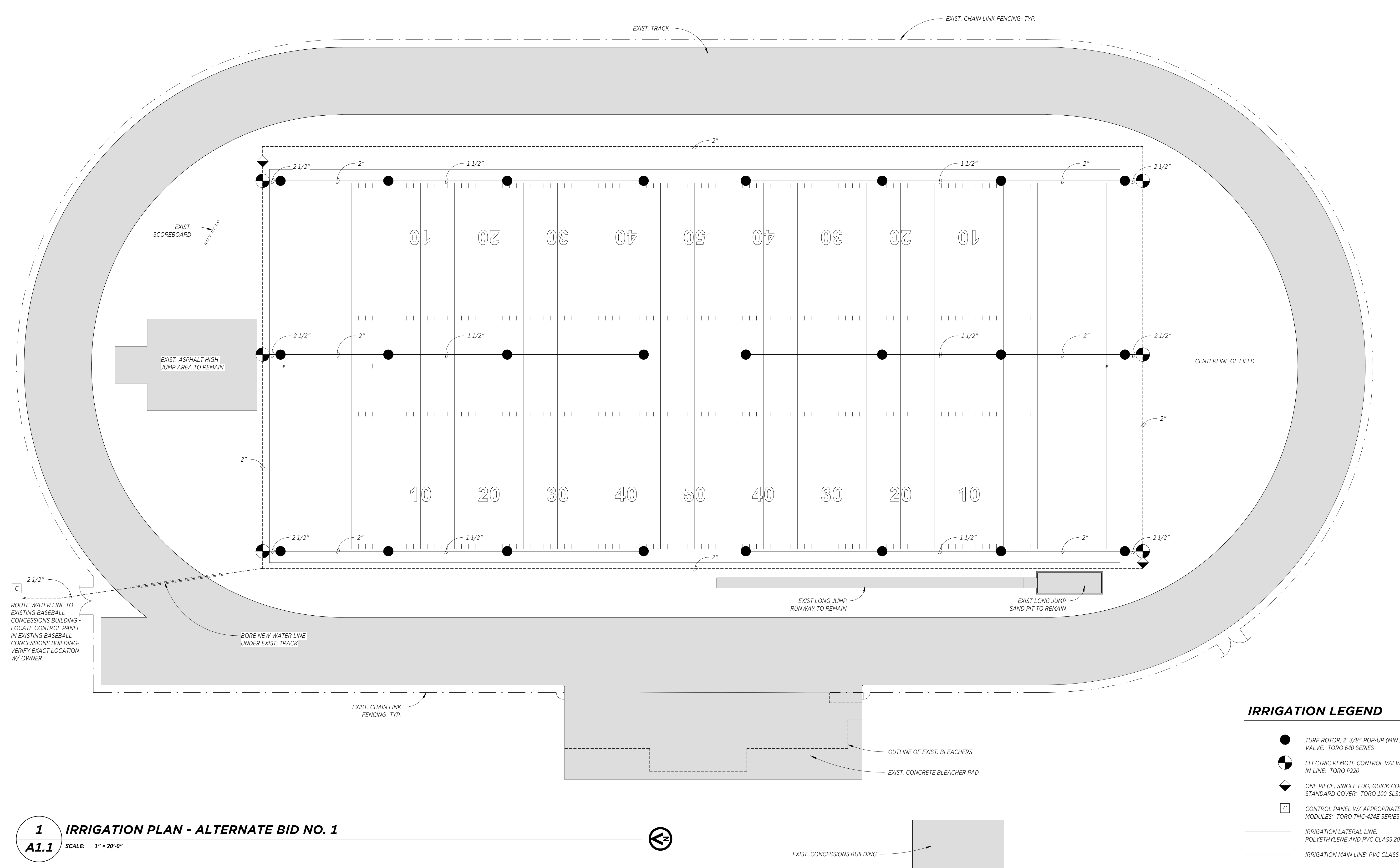

**1 IRRIGATION PLAN - ALTERNATE BID NO. 1**  
**A1.1** SCALE: 1" = 20'-0"

**IRRIGATION LEGEND**

- TURF ROTOR, 2 3/8" POP-UP (MIN.), W/ CHECK VALVE: TORO 640 SERIES
- ⊗ ELECTRIC REMOTE CONTROL VALVE, 60 Hz SOLENOID, IN-LINE: TORO P220
- ⊕ ONE PIECE, SINGLE LUG, QUICK COUPLER W/ STANDARD COVER: TORO 100-SLSC
- ⊞ CONTROL PANEL W/ APPROPRIATE EXPANSION MODULES: TORO TMC-424E SERIES
- IRRIGATION LATERAL LINE: POLYETHYLENE AND PVC CLASS 200
- - - IRRIGATION MAIN LINE: PVC CLASS 200 SDR 21

- GENERAL NOTES**
- ALTERNATE BID NO. 1** - COMPLETE IRRIGATION SYSTEM.
  - IRRIGATION SYSTEM SHALL PROVIDE FULL COVERAGE OF THE PLAYING FIELD. SPRAY PATTERN SHALL NOT EXTEND ONTO THE EXISTING TRACK SURFACE. COORDINATED LAYOUT OF SPRINKLER HEADS WITH OWNER.
  - CONTRACTOR SHALL DIRECTIONAL BORE UNDER THE EXISTING TRACK AS REQ. FOR NEW IRRIGATION MAINLINE.
  - CONTRACTOR SHALL COORDINATE WITH THE OWNER AND ARCHITECT THE LOCATION OF THE TRANSMISSION MAIN CONNECTION AND EQUIPMENT LOCATIONS IN THE EXISTING BUILDING.
  - THE CONSTANT PRESSURE PUMP CONTROL VALVE SHALL BE A CYCLE STOP VALVE MODEL NO. CSV3B2T AS MANUFACTURED BY CYCLE STOP VALVES, INC.
  - CONTRACTOR SHALL REMOVE AND REPAIR ALL ITEMS DAMAGED BY THE PROJECT WORK AT NO EXPENSE TO THE OWNER.

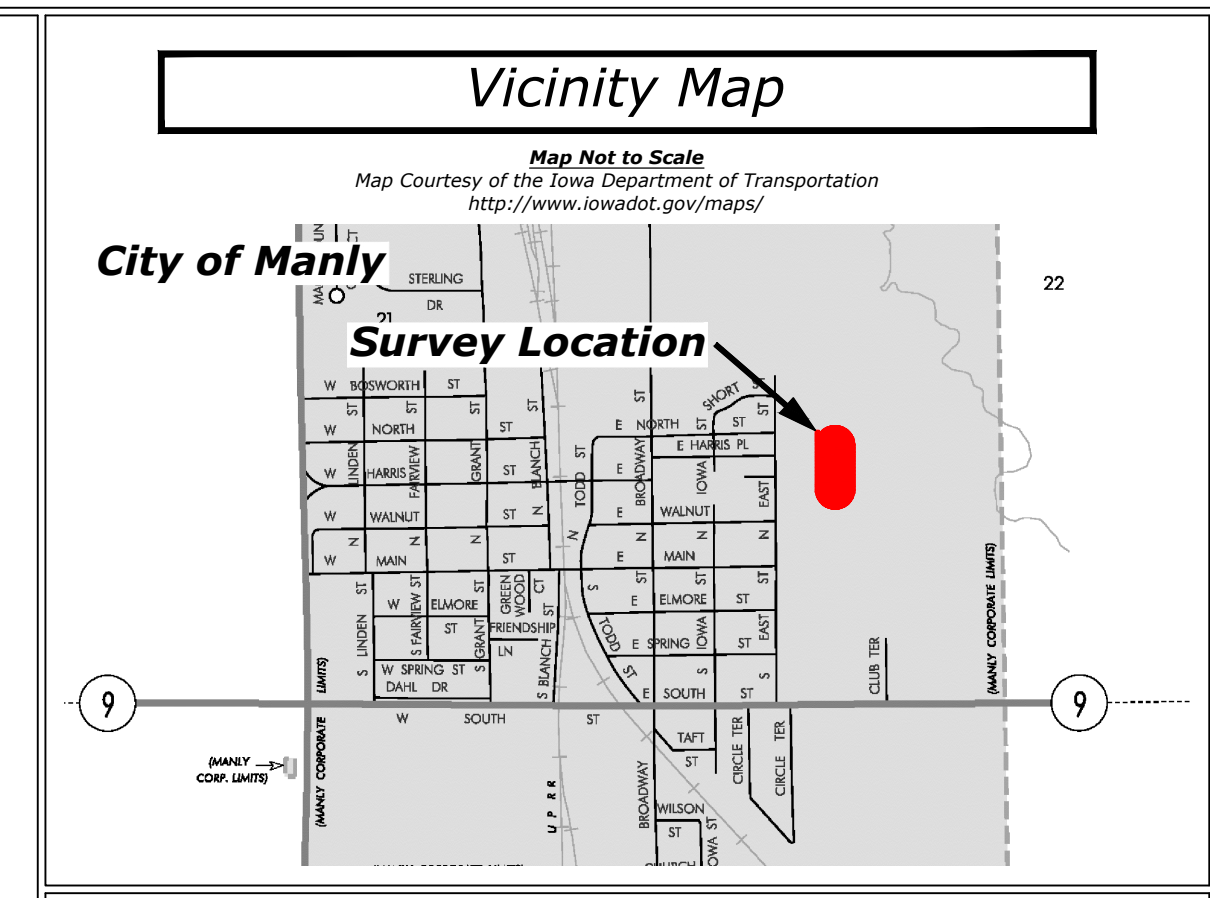

### Survey Legend

▲ = Section Corner as Noted	— = Survey Boundary Line
✕ = Placed Cut "X"	— = Right of Way Line
⊠ = Found Cut "X"	— = Road Centerline
● = Found 1/2"Ø Rebar w/RPC PLS 17344	— = Existing Underground Telephone Line
○ = Found 1/2"Ø Rebar w/YPC PLS 16775	— = Existing Natural Gas Line
■ = Found 1/2"Ø Rebar w/YPC PLS 8033	— = Existing Sanitary Sewer Line
□ = Found 1/2"Ø Rebar w/YPC PLS 2697	— = Existing Water Line
● = Found 1/2"Ø Rebar	— = Existing Storm Sewer Line
● = Found 3/4"Ø Iron Pipe	— = Existing Fiber Optic Line
● = YPC, RPC, GPC, PPC, BPC, MPC = Yellow, Red, Orange, Pink, Blue, Maroon Plastic Cap	— = Existing Overhead Electric Line
⊙ = Reference to Title Items	— = Existing Building Overhang
(0.00') = Recorded Dimension	— = Existing Chainlink Fence
⊕ = Sign Post	⊕ = Sanitary Sewer/Storm Drain Manhole (SSMH)(SDMH)
⊕ = Control Point	⊕ = Communications Manhole or Pedestal
⊕ = Traffic Signal Base	⊕ = Storm Drain Intake (INTK)
⊕ = Luminaire	⊕ = Undergroud Fiberoptic Box
⊕ = Electric Meter	⊕ = Deciduous Tree
⊕ = Fire Hydrant	⊕ = Sanitary Sewer Cleanout
⊕ = Gas Valve	⊕ = BSM = 1"Ø Bronze Survey Marker
⊕ = Fuel Tank Lid	⊕ = Water Shut-off
CP-PPC = Set 5/8"Ø Rebar x 24" Long with PPC	TR77C = Tree, Diameter in Inches, Deciduous
	TR77C = Tree, Diameter in Inches, Conifer

Note: Some of these items may not be included in this survey as this is our template legend.

### Utility Notes

**Structure Invert Information**

INTK #1	Rim Elev. - 1175.54' - Grate Lid FL Elev. - 1171.54'
INTK #2	Rim Elev. - 1173.67' - Grate Lid FL Elev. - 1171.17'
INTK #3	Rim Elev. - 1173.58' - Grate Lid FL Elev. - 1170.68'
INTK #4	Rim Elev. - 1173.65' - Grate Lid FL Elev. - 1170.85'
INTK #5	Rim Elev. - 1173.40' - Grate Lid FL Elev. - 1170.20'
INTK #6	Rim Elev. - 1173.53' - Grate Lid FL Elev. - 1169.26'
INTK #7	Rim Elev. - 1173.15' - Grate Lid FL Elev. - 1168.45'
INTK #8	Rim Elev. - 1173.46' - Grate Lid FL Elev. - 1168.51'
INTK #9	Rim Elev. - 1173.98' - Grate Lid FL Elev. - 1170.18'
INTK #10	Rim Elev. - 1173.48' - Grate Lid FL Elev. - 1169.43'
INTK #11	Rim Elev. - 1173.39' - Grate Lid FL Elev. - 1169.19'
INTK #12	Rim Elev. - 1173.47' - Grate Lid FL Elev. - 1168.72'
INTK #13	Rim Elev. - 1170.18' - Grate Lid FL Elev. - 1168.23'

### Basis of Bearing

The Coordinate Basis for this survey and the subsequent Basis of Bearing is the Iowa State Plane Coordinate System North Zone (1401) Horizontal Control NAD 83 (1996). Vertical Control NAVD83 (Geoid 03) Control was acquired by localizing into the Worth County GPS Control System utilizing Points 110, 111, 112, 519, 520, 525, 526, 531 and 532 and projected from Point 525. Scale factor 1.0004686 applied. Projection Point: Northing = 3,935,824.93' Easting = 5,000,825.22'

I hereby certify that this land surveying document was prepared and the related survey work was performed by me or under my direct personal supervision and that I am a duly licensed Land Surveyor under the laws of the State of Iowa.

Mark D. McClenathan  
License number 24510  
My license renewal date is December 31, 2021.  
Sheets covered by this seal: Individual Sheet Only.

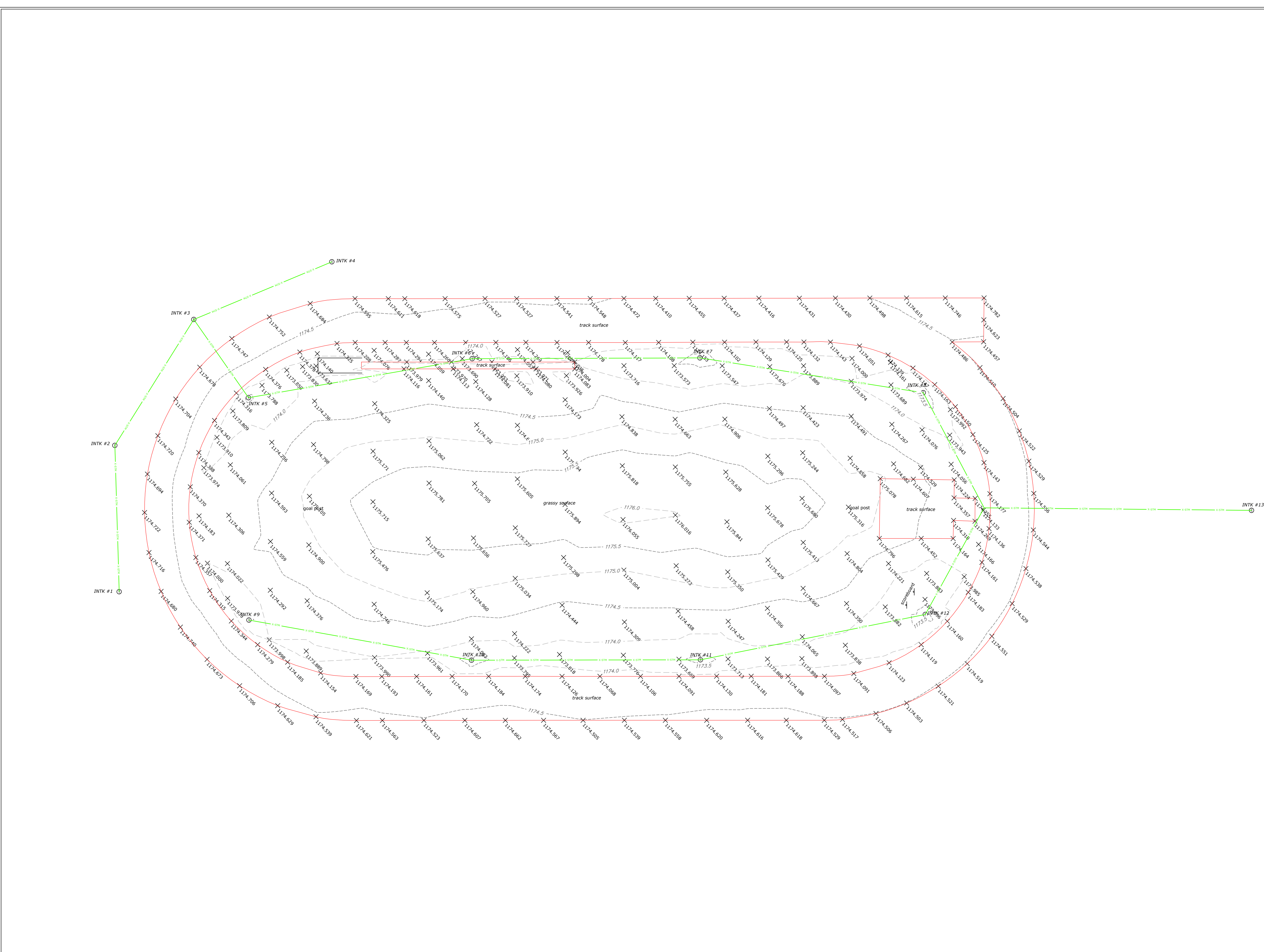

**Herold-Reicks Surveying**

New Hampton Waverly Clear Lake  
641-394-2725 319-483-5187 641-231-8092  
www.hrsurveying.com

Scale - 1 inch = 30 ft.

Proprietor: Central Springs Community Schools  
Requested by: Mark Kroemer, AIA  
FB: WORTH 11A, Pg. 4  
MDM/Project Number: 2020-359  
Fieldwork was completed on July 30, 2020.

## Existing Site Survey

### Central Springs High School Football Field

### 105 South East Street, Manly, Iowa 50456

File Path: \\projects - CLO\County Control Systems\WORTH-11A\_HRS\_ALTA\2020-359 Control Systems\2020-359.dwg, 8/17/2020 9:33:09 AM